

A detailed technical drawing of a window frame cross-section, rendered in a light yellow color against a darker yellow background. The drawing shows the internal structure of the frame, including the sash, the frame itself, and various seals and components. The lines are thin and precise, typical of architectural or engineering drawings.

hswam

Technical data

Door types

Classic door (c)

HWAM stoves with classic doors have a classic design expression. This is reflected in the steel frame surrounding the large glass on the stove door.

Models with classic doors are available with a steel front, except HWAM 7100, which always comes with a stone front.

Modern door (m)

HWAM stoves with modern doors have a design expression that closely follows the current trends. A modern door is a large visible glass on an invisible steel frame.

HWAM 2600 and HWAM 3600 with modern doors are available with steel fronts. HWAM 3100, HWAM 3200, HWAM 3400, HWAM 3500 and HWAM 4600 with modern doors are available with either glass or steel fronts.

HWAM 7100 always comes with a stone front.

HWAM 3120c (classic side hinged door)



HWAM 3120m (moderne side hinged door)



Stone cladding

For several of our stove models you can choose to have them delivered with either soapstone or sandstone cladding in the colour variants Tobacco, Wenge or Grey.

With these stones you can bring the raw natural look into your room and add your personal feature to your stove's look, while the stone cladding also extends the heating effect.



Grey sandstone

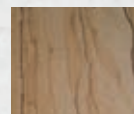

Tobacco sandstone

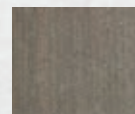

Wenge sandstone

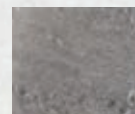

Soapstone



Contents

Products, Technical data	
HWAM 2610 / HWAM 2620	4
HWAM 2630 / HWAM 2640	5
HWAM 3110	6
HWAM 3120 / HWAM 3130	7
HWAM 3220c	8
HWAM 3220m	9
HWAM 3420c	10
HWAM 3420m	11
HWAM 3520c	12
HWAM 3520m	13
HWAM 3530c	14
HWAM 3530m	15
HWAM 3610 / HWAM 3620	16
HWAM 3630 / HWAM 3640	17
HWAM 3650	18
HWAM 3660	19
HWAM 4620 / HWAM 4640	20
HWAM 4660 / HWAM 4680	21
HWAM 7150	22
HWAM 7180	23
HWAM I 30/55 / HWAM I 30/55s	24
HWAM I 30/45 / HWAM I 30/65	25
HWAM Classic 4	26
HWAM Classic 7H	27
Product overview	28, 29
Distance to inflammable materials	30
Approvals	31
Test results	32, 33
Unique features	34
Heat storage	35

Technical data

Capacity	2-6 kW
Nominal heat output	4,5 kW
Smoke outlet	Ø 150 mm
Efficiency Autopilot/Autopilot IHS	80,3%/81,3%
Chimney draught, min. (recommended)	12 Pa

Weight

Weight HWAM 2610c/2610m	66/64 kg
Weight HWAM 2620c/2620m	66/64 kg
Weight pedestal	15 kg

Measurements

Width of combustion chamber	27,0 cm
Connection from floor with Autopilot*, top	65,1 cm
Connection from floor with Autopilot IHS*, top	67,8 cm
Connection from floor on plinth, top	68,1 cm
Connection from floor on plinth, IHS, top	70,8 cm
Connection from floor on pedestal, Autopilot, top	95,1 cm
Connection from floor on pedestal, Autopilot IHS, top	97,8 cm
Connection from wall to center of top outlet, wall-mounted	18,9 cm

* From the lower edge of the stove without plinth

Variants

Autopilot or Autopilot IHS
Classic door (c) or modern door (m)
Cast iron top, top outlet or back outlet
Pedestal, plinth or wall-mounted

Accessories

Combustion air system back/bottom



HWAM 2610c with side glasses and plinth



HWAM 2610m with side glasses



HWAM 2620c on pedestal

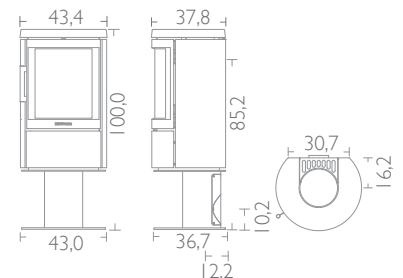
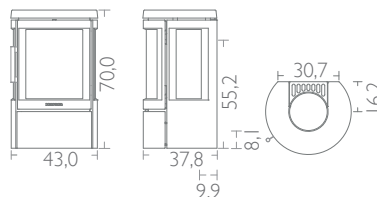
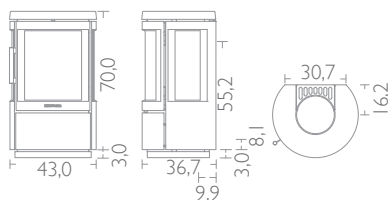

HWAM 15

S4

All drawings: The measurements for the flue outlet and fresh air connection have been given to the centre of the hole.

HWAM 2630 HWAM 2640

Technical data

Capacity	2-6 kW
Nominal heat output	4,5 kW
Smoke outlet	Ø 150 mm
Efficiency Autopilot/Autopilot IHS	80,3%/81,3%
Chimney draught, min. (recommended)	12 Pa

Weight

Weight HWAM 2630c/2630m	75/73 kg
Weight HWAM 2640c/2640m	75/73 kg

Measurements

Width of combustion chamber	27,0 cm
Connection from floor with Autopilot, top	95,1 cm
Connection from floor with Autopilot IHS, top	97,8 cm

Variants

Autopilot or Autopilot IHS
Classic door (c) or modern door (m)
Cast iron top, top outlet or back outlet

Accessories

Combustion air system back/bottom



HWAM 2630c with side glasses



HWAM 2640c



HWAM 2640m

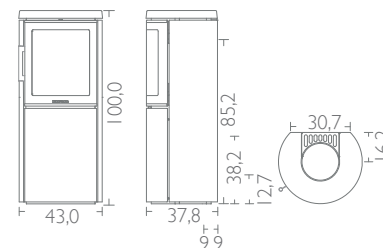
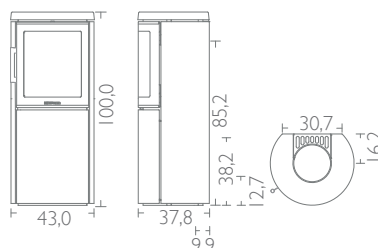
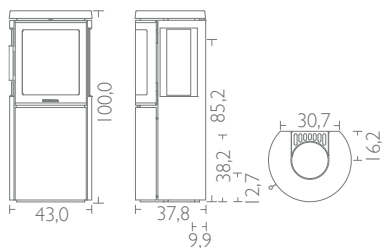

SPECIFICATIONS #15/ 16

All drawings: The measurements for the flue outlet and fresh air connection have been given to the centre of the hole.

S5

HWAM 3110

Technical data

Capacity	2-7 kW
Nominal heat output	4,5 kW
Smoke outlet	Ø 150 mm
Efficiency	78,1%
Chimney draught, min. (recommended)	12 Pa

Weight

Weight HWAM 3110c/3110m	87/84 kg
Weight with soapstone top HWAM 3110c/3110m	97/94 kg
Weight with sandstone top HWAM 3110c/3110m	94/91 kg
Weight pedestal	14 kg

Measurements

Width of combustion chamber	33,0 cm
Connection from floor with Autopilot*, top	69,8 cm
Connection from floor on plinth, top	72,8 cm
Connection from floor on pedestal, Autopilot, top	99,8 cm
Connection from wall to center of top outlet, wall-mounted	20,5 cm

* From the lower edge of the stove without plinth

Variants

- Autopilot
- Classic door (c) or modern door (m)
- Cast iron top, top outlet or back outlet
- Soapstone top, top outlet or back outlet
- Sandstone top, top outlet or back outlet
- Glass door (HWAM 3110m) or steel door at the bottom
- Pedestal, plinth or wall-mounted

Accessories

- Combustion air system back/bottom

Autopilot



HWAM 3110c with plinth



HWAM 3110m, steel door at the bottom



HWAM 3110m on pedestal, steel door at the bottom

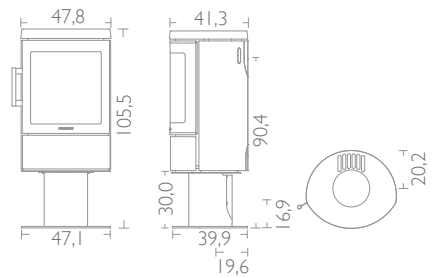
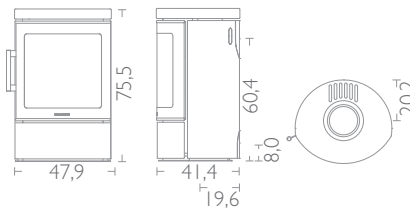
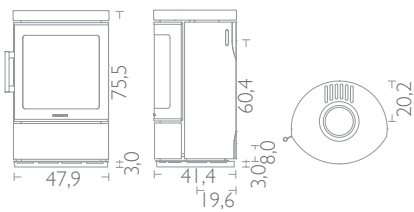

HWAM 15

S6

All drawings: The measurements for the flue outlet and fresh air connection have been given to the centre of the hole.

HWAM 3120

HWAM 3130

Technical data

Capacity	2-7 kW
Nominal heat output	4,5 kW
Smoke outlet	Ø 150 mm
Efficiency Autopilot/Autopilot IHS	78,1%/83,4%
Chimney draught, min. (recommended)	12 Pa

Weight

Weight HWAM 3120c/3120m	107/104 kg
Weight HWAM 3130c/3130m	113/110 kg
Weight with soapstone top HWAM 3120c/3120m	117/114 kg
Weight with sandstone top HWAM 3120c/3120m	114/111 kg
Weight with soapstone top HWAM 3130c/3130m	123/120 kg
Weight with sandstone top HWAM 3130c/3130m	120/117 kg
Weight, Heat storing stone	Ca. 32 kg

Measurements

Width of combustion chamber	33,0 cm
Connection from floor with Autopilot, top	94,8 cm
Connection from floor with Autopilot IHS, top	97,5 cm

Variants

- Autopilot or Autopilot IHS
- Classic door (c) or modern door (m)
- Cast iron top, top outlet or back outlet
- Soapstone top, top outlet or back outlet
- Sandstone top, top outlet or back outlet
- Glass front (HWAM 3120m/HWAM 3130m) or steel front on top/at the bottom

Accessories

- Combustion air system back/bottom
- Heat storage stones (HWAM 3130)



HWAM 3120c



HWAM 3120m, glass door at the bottom



HWAM 3130m with soapstone top, Steel front top and at the bottom

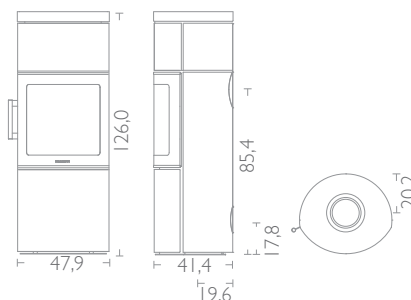
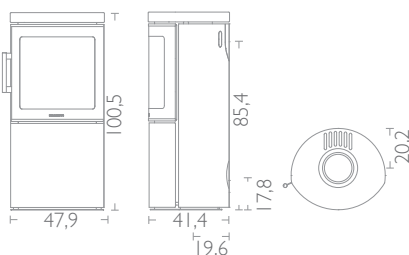
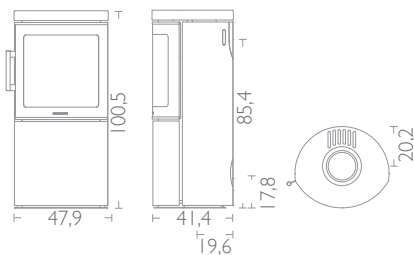

SPECIFICATIONS #15/ 16

All drawings: The measurements for the flue outlet and fresh air connection have been given to the centre of the hole.

S7

HWAM 3220c

Technical data

Capacity	2-7 kW
Nominal heat output	4,5 kW
Smoke outlet	Ø 150 mm
Efficiency Autopilot/Autopilot IHS	78,1%/83,4%
Chimney draught, min. (recommended)	12 Pa

Weight

Weight with soapstone top	91 kg
Weight with sandstone top	89 kg

Measurements

Width of combustion chamber	33,0 cm
Connection from floor with Autopilot, top	94,8 cm
Connection from floor with Autopilot IHS, top	97,5 cm

Variants

Autopilot or Autopilot IHS
Soapstone top, top outlet or back outlet
Sandstone top, top outlet or back outlet

Accessories

Combustion air system back/bottom



HWAM 3220c with soapstone top

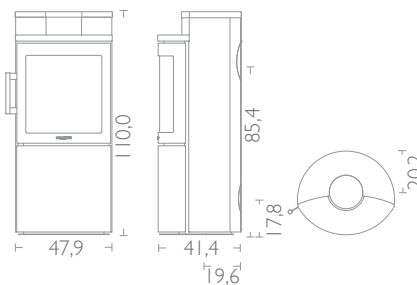

hwam 3220m

Technical data

Capacity	2-7 kW
Nominal heat output	4,5 kW
Smoke outlet	Ø 150 mm
Efficiency Autopilot/Autopilot IHS	78,1%/83,4%
Chimney draught, min. (recommended)	12 Pa

Weight

Weight with soapstone top	88 kg
Weight with sandstone top	86 kg

Measurements

Width of combustion chamber	33,0 cm
Connection from floor with Autopilot, top	94,8 cm
Connection from floor with Autopilot IHS, top	97,5 cm

Variants

- Autopilot or Autopilot IHS
- Soapstone top, top outlet or back outlet
- Sandstone top, top outlet or back outlet
- Glas door or steel door at the bottom

Accessories

- Combustion air system back/bottom



HWAM 3220m with soapstone top, steel door at the bottom

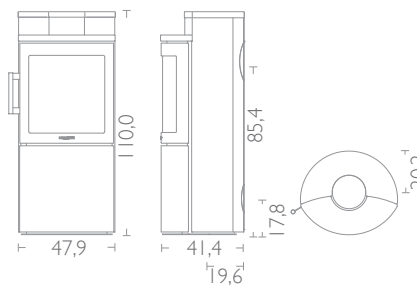

All drawings: The measurements for the flue outlet and fresh air connection have been given to the centre of the hole.

SPECIFICATIONS #15/ 16

S9

HWAM 3420c

Technical data

Capacity	2-7 kW
Nominal heat output	4,5 kW
Smoke outlet	Ø 150 mm
Efficiency Autopilot/Autopilot IHS	78,1%/83,4%
Chimney draught, min. (recommended)	12 Pa

Weight

Weight	107 kg
Weight with soapstone top	119 kg
Weight with sandstone top	115 kg
Weight with soapstone cover	149 kg
Weight with sandstone cover	139 kg

Measurements

Width of combustion chamber	33,0 cm
Connection from floor with Autopilot, top	95,0 cm
Connection from floor with Autopilot IHS, top	97,7 cm

Variants

- Autopilot or Autopilot IHS
- Cast iron top, top outlet or back outlet
- Soapstone top, top outlet or back outlet
- Sandstone top, top outlet or back outlet
- Soapstone cover, top outlet or back outlet
- Sandstone cover, top outlet or back outlet

Accessories

- Combustion air system back/bottom



HWAM 3420c



HWAM 3420c with soapstone cover

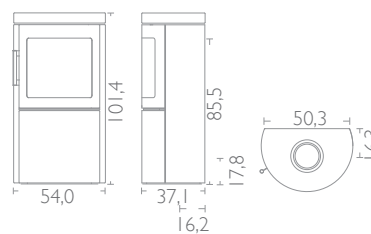
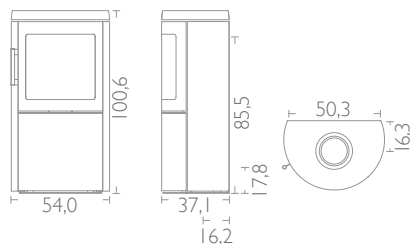

HWAM 15
S10

All drawings: The measurements for the flue outlet and fresh air connection have been given to the centre of the hole.

hwam 3420m

Technical data

Capacity	2-7 kW
Nominal heat output	4,5 kW
Smoke outlet	Ø 150 mm
Efficiency Autopilot/Autopilot IHS	78,3%/83,4%
Chimney draught, min. (recommended) Autopilot/Autopilot IHS	12 Pa

Weight

Weight	104 kg
Weight with soapstone top	116 kg
Weight with sandstone top	112 kg
Weight with soapstone cover	146 kg
Weight with sandstone cover	136 kg

Measurements

Width of combustion chamber	33,0 cm
Connection from floor with Autopilot, top	95,0 cm
Connection from floor with Autopilot IHS, top	97,7 cm

Variants

- Autopilot or Autopilot IHS
- Cast iron top, top outlet or back outlet
- Soapstone top, top outlet or back outlet
- Sandstone top, top outlet or back outlet
- Soapstone cover, top outlet or back outlet
- Sandstone cover, top outlet or back outlet
- Glas door or steel door at the bottom

Accessories

- Combustion air system back/bottom



HWAM 3420m, steel door at the bottom



HWAM 3420m with soapstone top, steel door at the bottom



HWAM 3420m with Wenge sandstone cover, glass door at the bottom

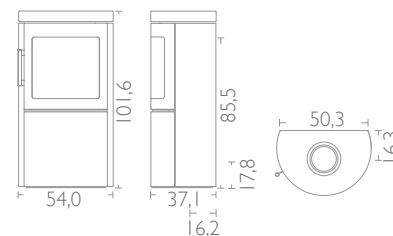
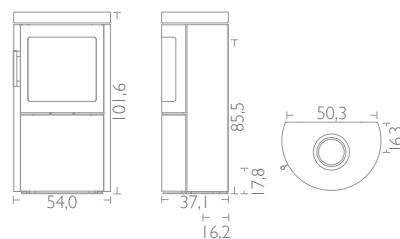
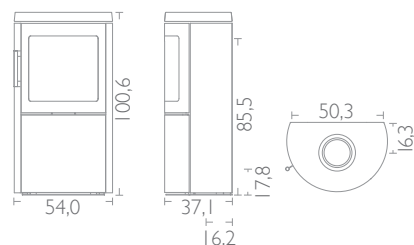

SPECIFICATIONS #15/ 16

All drawings: The measurements for the flue outlet and fresh air connection have been given to the centre of the hole.

S11

HWAM 3520c

Technical data

Capacity	2-7 kW
Nominal heat output	4,5 kW
Smoke outlet	Ø 150 mm
Efficiency Autopilot/Autopilot IHS	78,1%/83,4%
Chimney draught, min. (recommended)	12 Pa

Weight

Weight	118 kg
Weight with soapstone top	131 kg
Weight with sandstone top	127 kg
Weight with soapstone cover	167 kg
Weight with sandstone cover	155 kg
Weight, heat storage stones	Ca. 44 kg

Measurements

Width of combustion chamber	33,0 cm
Connection from floor with Autopilot, top	95,0 cm
Connection from floor with Autopilot IHS, top	97,7 cm

Variants

Autopilot or Autopilot IHS
Cast iron top, top outlet or back outlet
Soapstone top, top outlet or back outlet
Sandstone top, top outlet or back outlet
Soapstone cover, top outlet or back outlet
Sandstone cover, top outlet or back outlet

Accessories

Combustion air system back/bottom
Heat storage stones



HWAM 3520c



HWAM 3520c with grey sandstone cover

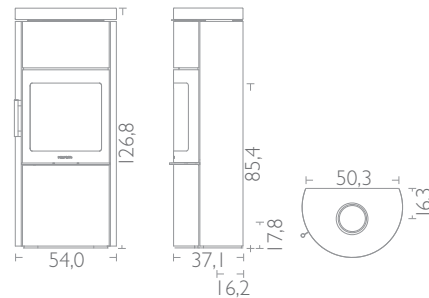
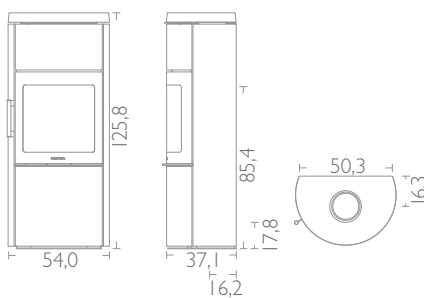

HWAM 3520m

Technical data

Capacity	2-7 kW
Nominal heat output	4,5 kW
Smoke outlet	Ø 150 mm
Efficiency Autopilot/Autopilot IHS	78,1%/83,4%
Chimney draught, min. (recommended) Autopilot/Autopilot IHS	12 Pa

Weight

Weight	115 kg
Weight with soapstone top	128 kg
Weight with sandstone top	124 kg
Weight with soapstone cover	164 kg
Weight with sandstone cover	152 kg
Weight, heat storage stones	Ca. 44 kg

Measurements

Width of combustion chamber	33,0 cm
Connection from floor with Autopilot, top	95,0 cm
Connection from floor with Autopilot IHS, top	97,7 cm

Variants

Autopilot or Autopilot IHS
Cast iron top, top outlet or back outlet
Soapstone top, top outlet or back outlet
Sandstone top, top outlet or back outlet
Soapstone cover, top outlet or back outlet
Sandstone cover, top outlet or back outlet
Glass or steel front top/bottom

Accessories

Combustion air system back/bottom
Heat storage stones



HWAM 3520m, Steel front at the top and bottom



HWAM 3520m with Tobacco sandstone top,
Glass front at the top and bottom



HWAM 3520m with soapstone top,
Glass front at the top and bottom

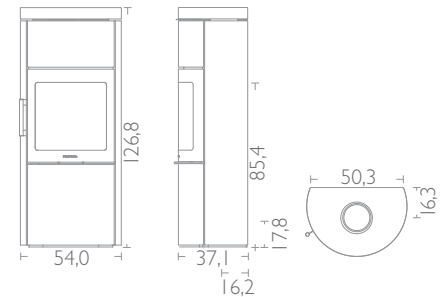
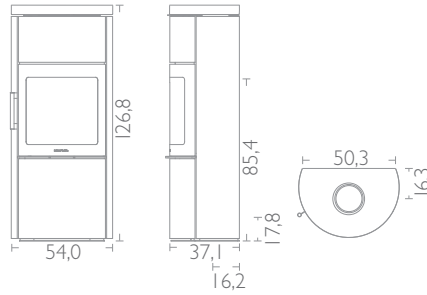
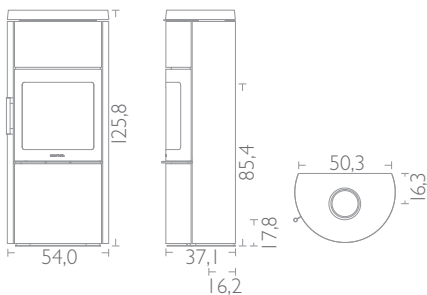

SPECIFICATIONS #15/ 16

All drawings: The measurements for the flue outlet and fresh air connection have been given to the centre of the hole.

S13

HWAM 3530c

Technical data

Capacity	2-7 kW
Nominal heat output	4,5 kW
Smoke outlet	Ø 150 mm
Efficiency Autopilot/Autopilot IHS	78,1%/83,4%
Chimney draught, min. (recommended)	12 Pa

Weight

Weight	131 kg
Weight with soapstone top	143 kg
Weight with sandstone top	139 kg
Weight with soapstone cover	191 kg
Weight with sandstone cover	178 kg
Weight, heat storage stones	Ca. 77 kg

Measurements

Width of combustion chamber	33,0 cm
Connection from floor with Autopilot, top	95,0 cm
Connection from floor with Autopilot IHS, top	97,7 cm

Variants

Autopilot or Autopilot IHS
Cast iron top, top outlet or back outlet
Soapstone top, top outlet or back outlet
Sandstone top, top outlet or back outlet
Soapstone cover, top outlet or back outlet
Sandstone cover, top outlet or back outlet

Accessories

Combustion air system back/bottom
Heat storage stones



HWAM 3530c



HWAM 3530c with soapstone top



HWAM 3530c with Wenge sandstone top

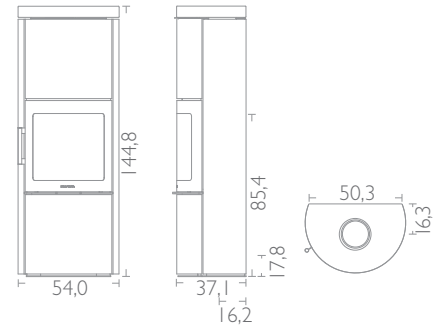
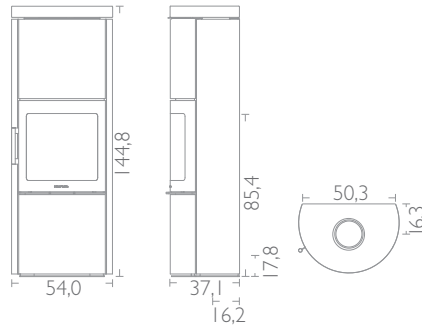
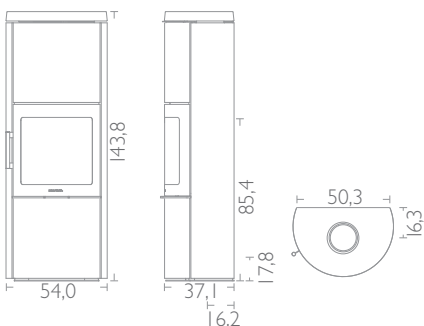

HWAM 15

S14

All drawings: The measurements for the flue outlet and fresh air connection have been given to the centre of the hole.

hwam 3530m

Technical data

Capacity	2-7 kW
Nominal heat output	4,5 kW
Smoke outlet	Ø 150 mm
Efficiency Autopilot/Autopilot IHS	78,1%/83,4%
Chimney draught, min. (recommended)	12 Pa

Weight

Weight	128 kg
Weight with soapstone top	140 kg
Weight with sandstone top	136 kg
Weight with soapstone cover	188 kg
Weight with sandstone cover	175 kg
Weight, heat storage stones	Ca. 77 kg

Measurements

Width of combustion chamber	33,0 cm
Connection from floor with Autopilot, top	95,0 cm
Connection from floor with Autopilot IHS, top	97,7 cm

Variants

- Autopilot or Autopilot IHS
- Cast iron top, top outlet or back outlet
- Soapstone top, top outlet or back outlet
- Sandstone top, top outlet or back outlet
- Soapstone cover, top outlet or back outlet
- Sandstone cover, top outlet or back outlet
- Glass front or steel front top/bottom

Accessories

- Combustion air system back/bottom
- Heat storage stones



HWAM 3530m with soapstone cover;
Glass front at the top and bottom

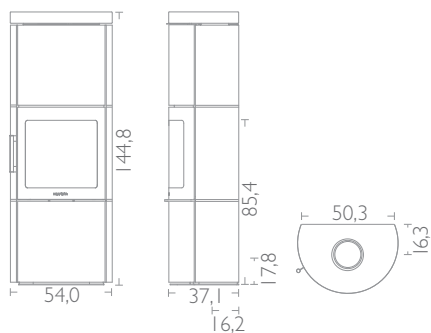

HWAM 3530m with Tobacco sandstone cover;
Glass at the top and bottom

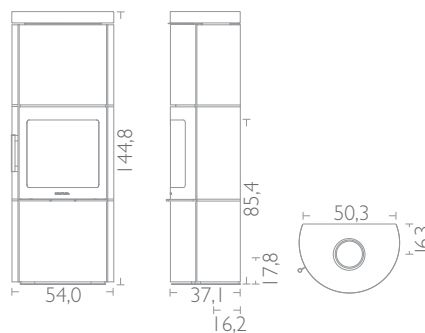

SPECIFICATIONS #15/ 16

All drawings: The measurements for the flue outlet and fresh air connection have been given to the centre of the hole.

S15

HWAM 3610

HWAM 3620

Technical data

Capacity	3-9 kW
Nominal heat output	6,0 kW
Smoke outlet	Ø 150 mm
Efficiency Autopilot/Autopilot IHS	78,3%/80,7%
Chimney draught, min. (recommended) Autopilot/Autopilot IHS	11 Pa/12 Pa

Weight

Weight HWAM 3610c/3610m	115/112 kg
Weight HWAM 3620c/3620m	115/112 kg
Weight, pedestal	20 kg

Measurements

Width of combustion chamber	35,0 cm
Connection from floor* with Autopilot, top	73,6 cm
Connection from floor on plinth, Autopilot, top	80,6 cm
Connection from floor on pedestal, Autopilot, top	108,2 cm
Connection from floor on pedestal with Autopilot IHS, top	110,9 cm
Connection from wall to center of top outlet, wall-mounted	20,0 cm

*From the lower edge of the stove without plinth

Variants

- Autopilot (alle Variants) or Autopilot IHS (only on pedestal)
- Classic door (c) or modern door (m)
- Cast iron top, top outlet or back outlet
- Pedestal, plinth or wall-mounted

Accessories

- Combustion air system back/bottom



HWAM 3610c with side glasses



HWAM 3610m with side glasses and plinth



HWAM 3620c on pedestal

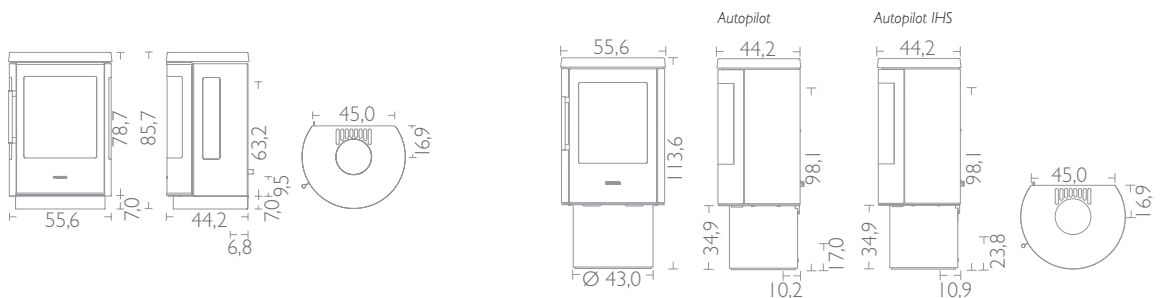

HWAM 3630

HWAM 3640

Technical data

Capacity	3-9 kW
Nominal heat output	6,0 kW
Smoke outlet	Ø 150 mm
Efficiency Autopilot/Autopilot IHS	78,3%/80,7%
Chimney draught, min. (recommended) Autopilot/Autopilot IHS	11 Pa/12 Pa

Weight

Weight HWAM 3630c/3630m	139/136 kg
Weight HWAM 3640c/3640m	139/136 kg
Weight with soapstone cover HWAM 3640c/3640m	229/226 kg
Weight with sandstone cover HWAM 3640c/3640m	211/208 kg

Measurements

Width of combustion chamber	35,0 cm
Connection from floor with Autopilot, top	109,6 cm
Connection from floor with Autopilot IHS, top	112,3 cm

Variants

- Autopilot or Autopilot IHS
- Classic door (c) or modern door (m)
- Cast iron top, top outlet or back outlet
- Soapstone cover, top outlet or back outlet
- Sandstone cover, top outlet or back outlet

Accessories

- Combustion air system back/bottom



HWAM 3630c with side glasses

HWAM 3640c with soapstone cover

HWAM 3640m

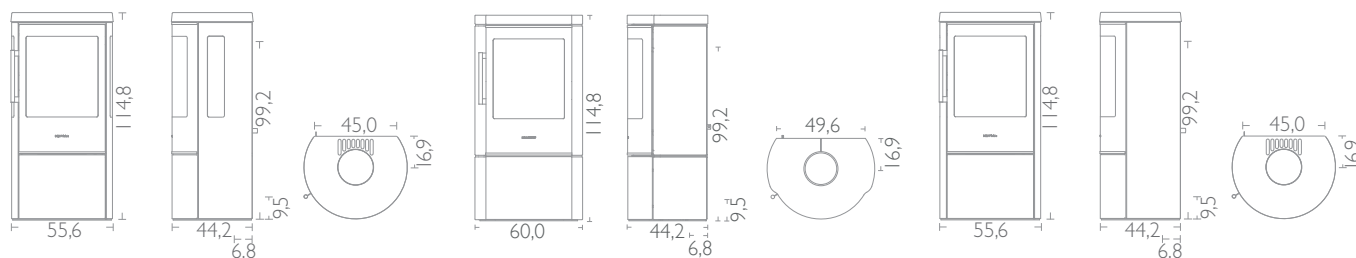

All drawings: The measurements for the flue outlet and fresh air connection have been given to the centre of the hole.

SPECIFICATIONS #15/ 16

S17

HWAM 3650

Technical data

Capacity	3-9 kW
Nominal heat output	6,0 kW
Smoke outlet	Ø 150 mm
Efficiency Autopilot/Autopilot IHS	78,3%/80,7%
Chimney draught, min. (recommended) Autopilot/Autopilot IHS	11 Pa/12 Pa

Weight

Weight HWAM 3650c/3650m	171/168 kg
Weight, heat storage stones	Ca. 55 kg

Measurements

Width of combustion chamber	35,0 cm
Connection from floor with Autopilot, top	109,6 cm
Connection from floor with Autopilot IHS, top	112,3 cm

Variants

Autopilot or Autopilot IHS
Classic door (c) or modern door (m)
Cast iron top, top outlet or back outlet

Accessories

Combustion air system back/bottom
Heat storage stones



HWAM 3650c with side glasses



HWAM 3650m with side glasses

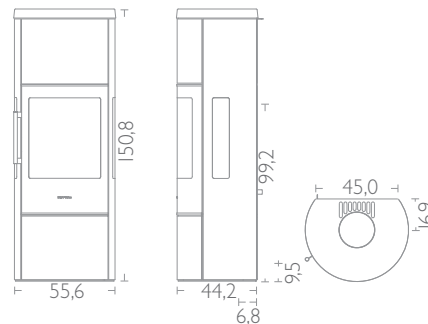
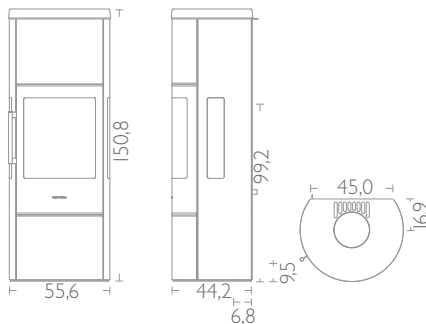

HWAM 3660

Technical data

Capacity	3-9 kW
Nominal heat output	6,0 kW
Smoke outlet	Ø 150 mm
Efficiency Autopilot/Autopilot IHS	78,3%/80,7%
Chimney draught, min. (recommended) Autopilot/Autopilot IHS	11 Pa/12 Pa

Weight

Weight HWAM 3660c/3660m	171/168 kg
Weight with soapstone cover HWAM 3660c/3660m	282/279 kg
Weight with sandstone cover HWAM 3660c/3660m	260/257 kg
Weight, heat storage stones	Ca. 55 kg

Measurements

Width of combustion chamber	35,0 cm
Connection from floor with Autopilot, top	109,6 cm
Connection from floor with Autopilot IHS, top	112,3 cm

Variants

- Autopilot or Autopilot IHS
- Classic door (c) or modern door (m)
- Cast iron top, top outlet or back outlet
- Soapstone cover, top outlet or back outlet
- Sandstone cover, top outlet or back outlet

Accessories

- Combustion air system back/bottom
- Heat storage stones



HWAM 3660c

HWAM 3660m with Wenge sandstone cover

HWAM 3660m with soapstone cover

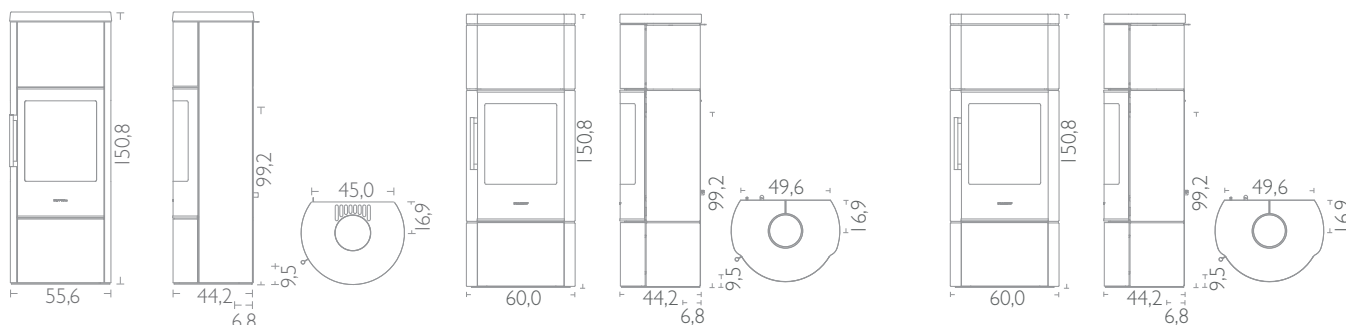

SPECIFICATIONS #15/ 16

All drawings: The measurements for the flue outlet and fresh air connection have been given to the centre of the hole.

HWAM 4620 HWAM 4640

Technical data

Capacity	3-9 kW
Nominal heat output Autopilot/Autopilot IHS	7,0 kW/8,0 kW
Smoke outlet	Ø 150 mm
Efficiency Autopilot/Autopilot IHS	80%/81%
Chimney draught, min. (recommended)	12 Pa

Weight

Weight HWAM 4620c/4620m	119/117 kg
Weight HWAM 4640c/4640m	133/131 kg
Weight with soapstone cover HWAM 4620c/4620m	164/162 kg
Weight with soapstone cover HWAM 4640c/4640m	197/195 kg
Weight with sandstone cover HWAM 4620c/4620m	153/151 kg
Weight with sandstone cover HWAM 4640c/4640m	182/180 kg

Measurements

Width of combustion chamber	49,0 cm
Connection from floor; top, HWAM 4620	81,9 cm
Connection from floor; top, HWAM 4640	111,4 cm

Variants

Autopilot or Autopilot IHS
Classic door (c) or modern door (m)
Cast iron top, top outlet or back outlet
Soapstone cover, top outlet or back outlet
Sandstone cover, top outlet or back outlet
Glass door (HWAM 4620m/4640m) or steel door at the bottom

Accessories

Combustion air system back/bottom

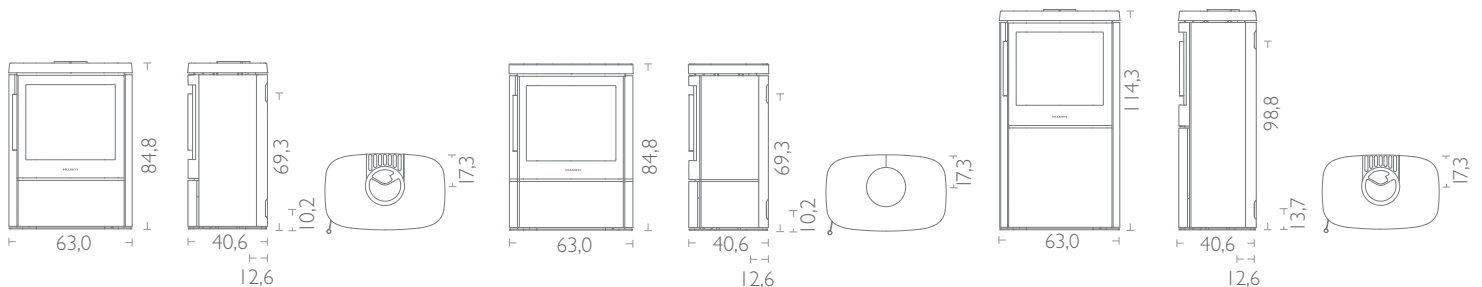

HWAM 15
S20

All drawings: The measurements for the flue outlet and fresh air connection have been given to the centre of the hole.

HWAM 4660

HWAM 4680

Technical data

Capacity	3-9 kW
Nominal heat output Autopilot/Autopilot IHS	7,0 kW/8,0 kW
Smoke outlet	Ø 150 mm
Efficiency Autopilot/Autopilot IHS	80%/81%
Chimney draught, min. (recommended)	12 Pa

Weight

Weight HWAM 4660c/4660m	153/151 kg
Weight HWAM 4680c/4680m	172/170 kg
Weight with soapstone cover HWAM 4660c/4660m	224/222 kg
Weight with soapstone cover HWAM 4680c/4680m	258/256 kg
Weight with sandstone cover HWAM 4660c/4660m	209/207 kg
Weight with sandstone cover HWAM 4680c/4680m	237/235 kg
Weight, heat storage stones HWAM 4660	Ca. 45 kg
Weight, heat storage stones HWAM 4680	Ca. 111 kg

Measurements

Width of combustion chamber	49,0 cm
Connection from floor; top, HWAM 4660	111,4 cm
Connection from floor; top, HWAM 4680	111,4 cm

Variants

- Autopilot or Autopilot IHS
- Classic door (c) or modern door (m)
- Cast iron top, top outlet or back outlet
- Soapstone cover, top outlet or back outlet
- Sandstone cover, top outlet or back outlet
- Glass front (HWAM 4660m/4680m) or steel front top/bottom

Accessories

- Combustion air system back/bottom
- Heat storing stone



HWAM 4660c

HWAM 4660m, Glass front at the top and bottom

HWAM 4680m with Tobacco sandstone cover, Glass front at the top and bottom

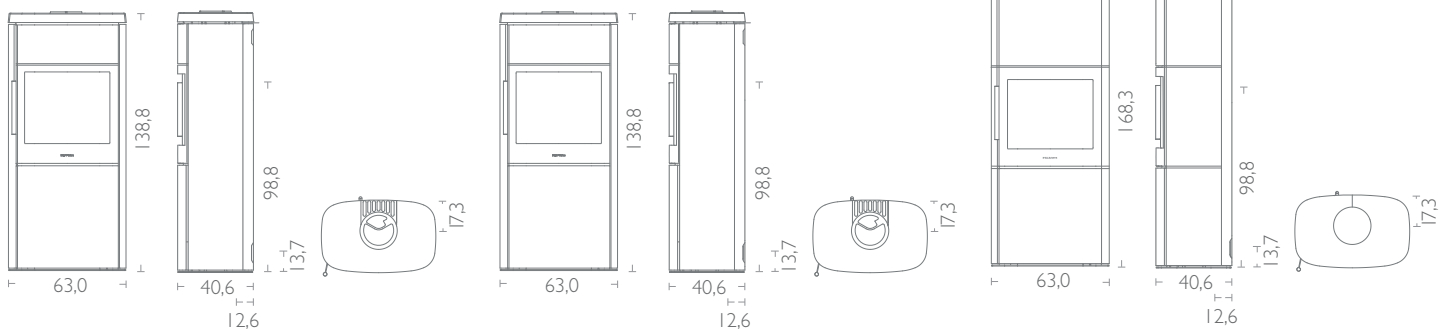

SPECIFICATIONS #15/16

All drawings: The measurements for the flue outlet and fresh air connection have been given to the centre of the hole.

S21

HWAM 7150

Technical data

Capacity	2-7 kW
Nominal heat output	4,5 kW
Smoke outlet	Ø 150 mm
Efficiency Autopilot/Autopilot IHS	80,9%/80,5%
Chimney draught, min. (recommended)	12 Pa

Weight

Weight with soapstone cover HWAM 7150c/7150m	462/459 kg
Weight with sandstone cover HWAM 7150c/7150m	409/406 kg
Weight, heat storage stones	Ca. 50 kg

Measurements

Width of combustion chamber	33,0 cm
Connection from floor; top	138,1 cm

Variants

Autopilot or Autopilot IHS
Classic door (c) or modern door (m)
Soapstone cover; top outlet or back outlet
Sandstone cover; top outlet or back outlet

Accessories

Combustion air system back/bottom
Heat storage stones



HWAM 7150c with soapstone cover



HWAM 7150c with Tobacco sandstone cover



HWAM 7150m with Wenge sandstone cover

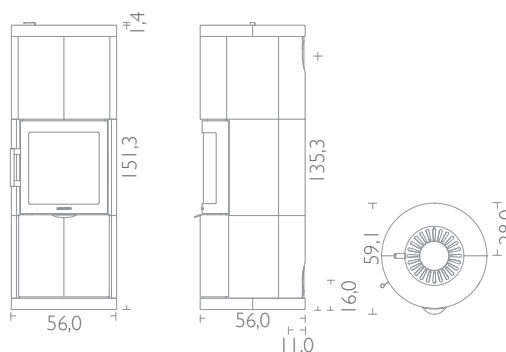

All drawings: The measurements for the flue outlet and fresh air connection have been given to the centre of the hole.

hwam 7180

Technical data

Capacity	2-7 kW
Nominal heat output	4,5 kW
Smoke outlet	Ø 150 mm
Efficiency Autopilot/Autopilot IHS	80,9%/80,5%
Chimney draught, min. (recommended)	12 Pa

Weight

Weight with soapstone cover HWAM 7180c/7180m	524/521 kg
Weight with sandstone cover HWAM 7180c/7180m	461/458 kg
Weight, heat storage stones	Ca. 90 kg

Measurements

Width of combustion chamber	33,0 cm
Connection from floor, top	168,1 cm

Variants

- Autopilot or Autopilot IHS
- Classic door (c) or modern door (m)
- Soapstone cover, top outlet or back outlet
- Sandstone cover, top outlet or back outlet

Accessories

- Combustion air system back/bottom
- Heat storage stones



HWAM 7180c with soapstone cover



HWAM 7180m with grey sandstone cover



HWAM 7180m with Wenge sandstone cover

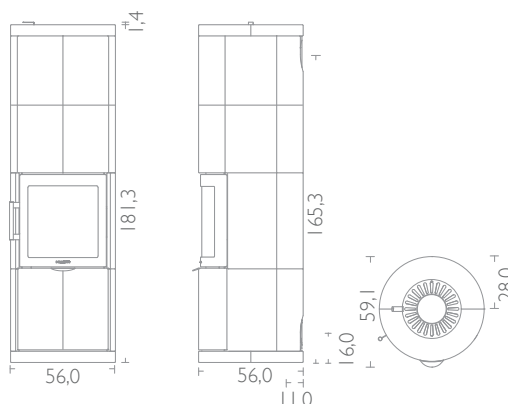

All drawings: The measurements for the flue outlet and fresh air connection have been given to the centre of the hole.

SPECIFICATIONS #15/ 16

S23

Technical data

Capacity	4-10 kW
Nominal heat output	7 kW
Smoke outlet	Ø150 mm
Efficiency	80,7%
Chimney draught, min. (recommended)	12 Pa

Weight

Weight HWAM I 30/55	98 kg
Weight HWAM I 30/55s	92 kg

Measurements

Width of combustion chamber	55,0 cm
-----------------------------	---------

Variants

Autopilot
Lifting door (HWAM I 30/55) or side hinged door (HWAM I 30/55s)
Top outlet or back outlet

Accessories

Combustion air system back/bottom



HWAM I 30/55



HWAM I 30/55s



HWAM I 30/55s

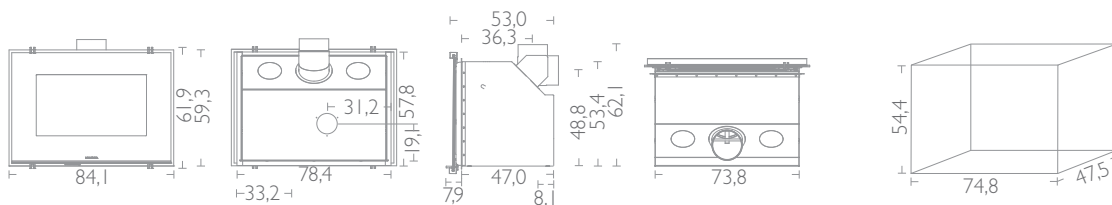

hwam | 30/45

hwam | 30/65

Technical data

Capacity HWAM I 30/45	2-7 kW
Capacity HWAM I 30/65	6-14 kW
Nominal heat output HWAM I 30/45	4,5 kW
Nominal heat output HWAM I 30/65	10 kW
Smoke outlet	Ø150 mm
Efficiency HWAM I 30/45	80,3%
Efficiency HWAM I 30/65	78,5%
Chimney draught, min. (recommended)	12 Pa

Weight

Weight HWAM I 30/45	82 kg
Weight HWAM I 30/65	126 kg

Measurements

Width of combustion chamber HWAM I 30/45	34,0 cm
Width of combustion chamber HWAM I 30/65	81,0 cm

Variants

- Autopilot
- Top outlet or back outlet

Accessories

- Combustion air system back (HWAM I 30/45 - HWAM I 30/65)
- Combustion air system bottom (HWAM I 30/45)

Autopilot



HWAM I 30/45



HWAM I 30/65

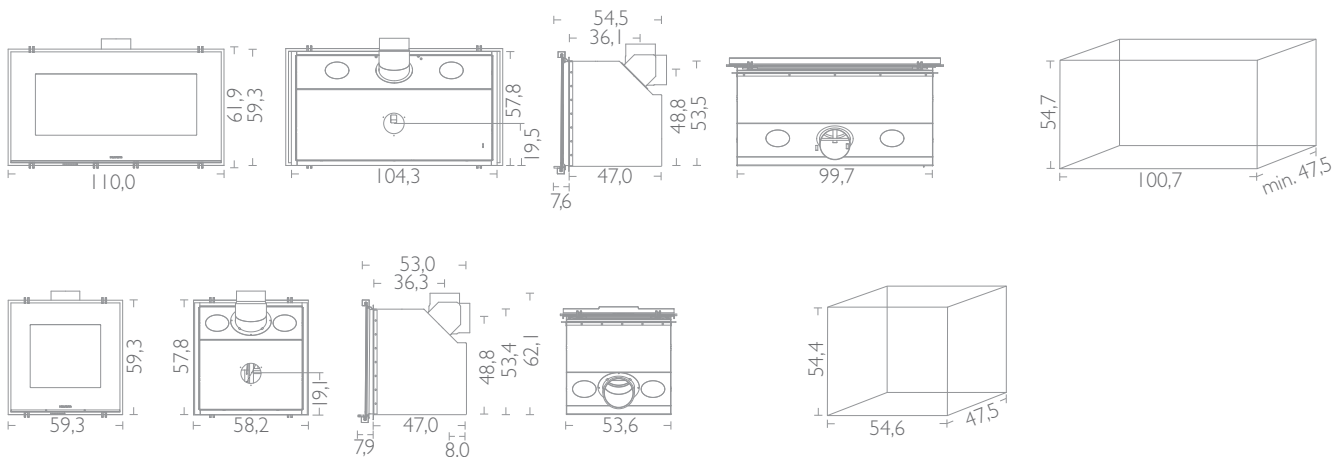

All drawings: The measurements for the flue outlet and fresh air connection have been given to the centre of the hole.

SPECIFICATIONS #15/ 16

S25

HWAM Classic 4

Technical data

Capacity	3-8 kW
Nominal heat output	8 kW
Smoke outlet	Ø 150 mm
Efficiency	79,3%
Chimney draught, min. (recommended)	12 Pa

Weight

Weight	108 kg
Weight with plinth	120 kg
Weight with baking oven	178 kg
Weight with plinth and baking oven	190 kg

Measurements

Width of combustion chamber	40,0 cm
Baking oven, H x W x D	22,5 x 46,6 x 23,7 cm
Connection from floor; top	68,7 cm
Connection from floor with plinth, top	90,7 cm
Connection from floor with baking oven, top	108,5 cm
Connection from floor with plinth and baking oven	130,5 cm

Variants

Autopilot
Top outlet or back outlet (not with baking oven)
Plinth
Baking oven

Autopilot



HWAM Classic 4



HWAM Classic 4 with plinth and baking oven

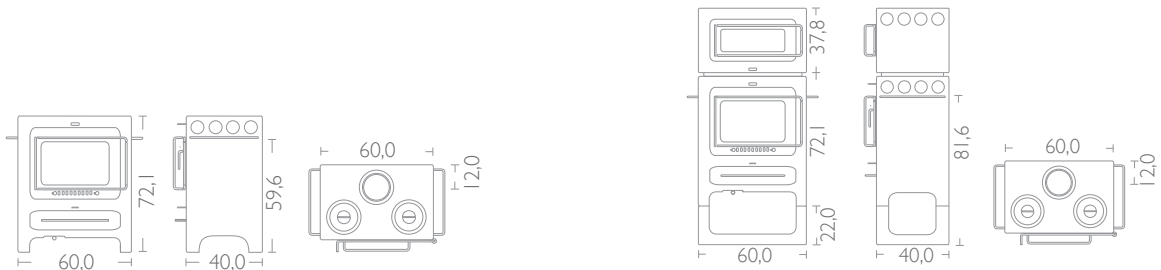

HWAM 15

S26

All drawings: The measurements for the flue outlet and fresh air connection have been given to the centre of the hole.

HWAM Classic 7H

Technical data

Capacity	8-14 kW
Nominal heat output	11 kW
Smoke outlet	Ø 180 mm
Efficiency	79,3%
Chimney draught, min. (recommended)	12 Pa

Weight

Weight	184 kg
--------	--------

Measurements

Width of combustion chamber	46,0 cm
Cooking section, H x W x D	21,9 x 45,8 x 28,7 cm
Connection from floor; top	116,6 cm

Variants

Autopilot
Top outlet or back outlet
Cooking section door

Autopilot



HWAM Classic 7H

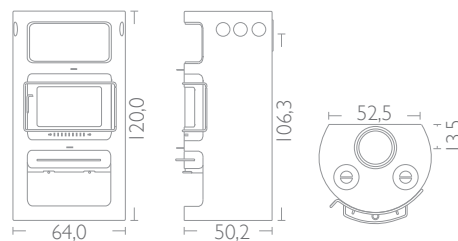

All drawings: The measurements for the flue outlet and fresh air connection have been given to the centre of the hole.

SPECIFICATIONS #15/ 16

S27

Product overview

	Nominal heat output <5 kW	Nominal heat output 5-6 kW	Nominal heat output >6 kW	HWAM Autopilot	HWAM Autopilot IHS	Classic door	Modern door	Side hinged door	Unique Door System (Lifting door)	Side glasses	Steel front	Glass front	Wall-mounted	Pedestal	Heat storage compartment	Combustion air system back	Combustion air system bottom	Wood section	Soapstone cover/Sandstone cover	Soapstone top/Sandstone top
HWAM 2610c	x			x	x	x		x		x	x		x	x		x	x			
HWAM 2610m	x			x	x		x	x		x	x		x	x		x	x			
HWAM 2620c	x			x	x	x		x			x		x	x		x	x			
HWAM 2620m	x			x	x		x	x			x		x	x		x	x			
HWAM 2630c	x			x	x	x		x		x	x					x	x			
HWAM 2630m	x			x	x		x	x		x	x					x	x			
HWAM 2640c	x			x	x	x		x			x					x	x			
HWAM 2640m	x			x	x		x	x			x					x	x			
HWAM 3110c	x			x		x		x			x		x	x		x	x			x
HWAM 3110m	x			x			x	x			x	x	x	x		x	x			x
HWAM 3120c	x			x	x	x		x			x					x	x			x
HWAM 3120m	x			x	x		x	x			x	x				x	x			x
HWAM 3130c	x			x	x	x		x			x				x	x	x			x
HWAM 3130m	x			x	x		x	x			x	x			x	x	x			x
HWAM 3220c	x			x	x	x		x			x					x	x			x
HWAM 3220m	x			x	x		x	x			x	x				x	x			x
HWAM 3420c	x			x	x	x		x			x					x	x		x	x
HWAM 3420m	x			x	x		x	x			x	x				x	x		x	x
HWAM 3520c	x			x	x	x		x			x				x	x	x		x	x
HWAM 3520m	x			x	x		x	x			x	x			x	x	x		x	x
HWAM 3530c	x			x	x	x		x			x				x	x	x		x	x
HWAM 3530m	x			x	x		x	x			x	x			x	x	x		x	x
HWAM 3610c		x		x	x*	x		x		x	x		x	x		x	x			
HWAM 3610m		x		x	x*		x	x		x	x		x	x		x	x			
HWAM 3620c		x		x	x*	x		x			x		x	x		x	x			
HWAM 3620m		x		x	x*		x	x			x		x	x		x	x			
HWAM 3630c		x		x	x	x		x		x	x					x	x			
HWAM 3630m		x		x	x		x	x		x	x					x	x			
HWAM 3640c		x		x	x	x		x			x					x	x		x	
HWAM 3640m		x		x	x		x	x			x					x	x		x	
HWAM 3650c		x		x	x	x		x		x	x				x	x	x			
HWAM 3650m		x		x	x		x	x		x	x				x	x	x			
HWAM 3660c		x		x	x	x		x			x				x	x	x		x	
HWAM 3660m		x		x	x		x	x			x				x	x	x		x	

* Only with pedestal

Product overview

	Nominal heat output <5 kW	Nominal heat output 5-6 kW	Nominal heat output >6 kW	HWAM Autopilot	HWAM Autopilot IHS	Classic door	Modern door	Side hinged door	Unique Door System (Lifting door)	Side glasses	Steel front	Glass front	Wall-mounted	Pedestal	Heat storage compartment	Combustion air system back	Combustion air system bottom	Wood section	Soapstone cover/Sandstone cover	Soapstone top/Sandstone top
HWAM 4620c			x	x	x	x		x			x					x	x		x	
HWAM 4620m			x	x	x		x	x			x	x				x	x		x	
HWAM 4640c			x	x	x	x		x			x					x	x		x	
HWAM 4640m			x	x	x		x	x			x	x				x	x		x	
HWAM 4660c			x	x	x	x		x			x				x	x	x		x	
HWAM 4660m			x	x	x		x	x			x	x			x	x	x		x	
HWAM 4680c			x	x	x	x		x			x				x	x	x		x	
HWAM 4680m			x	x	x		x	x			x	x			x	x	x		x	
HWAM 7150c	x			x	x	x		x							x	x	x		x	
HWAM 7150m	x			x	x		x	x							x	x	x		x	
HWAM 7180c	x			x	x	x		x							x	x	x		x	
HWAM 7180m	x			x	x		x	x							x	x	x		x	
HWAM I 30/45	x			x					x							x	x			
HWAM I 30/55			x	x					x							x	x			
HWAM I 30/55s			x	x				x								x	x			
HWAM I 30/65			x	x					x							x				
HWAM Classic 4			x	x				x											x	
HWAM Classic 7H			x	x				x											x	

Distance to inflammable materials

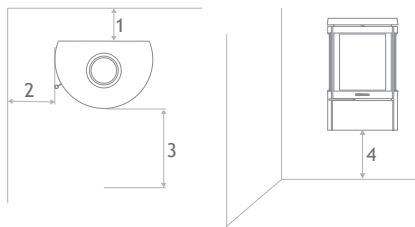

	1. Behind Cm. min.	2. Side Cm. min.	3. Distance to furnishing in front Cm. min.	4. Above inflammable floor Cm. min.	1. Distance to inflammable wall, corner location Cm. min.	2. Distance to inflammable wall, corner location Cm. min.
HWAM 2610	19	36	80	3	34 ⁽³⁾	56 ⁽³⁾
HWAM 2620	19	36	80	3	20 ⁽³⁾	42 ⁽³⁾
HWAM 2630	19	36	80	-	34 ⁽³⁾	56 ⁽³⁾
HWAM 2640	19	36	80	-	20 ⁽³⁾	42 ⁽³⁾
HWAM 3110	10	20	80	3	13	34
HWAM 3120	10	20	80	-	13	34
HWAM 3130	10	20	80	-	13	34
HWAM 3220	10	20	80	-	13	34
HWAM 3420	10	20	80	-	13 ⁽³⁾	43 ⁽³⁾
HWAM 3520	10	20	80	-	13 ⁽³⁾	43 ⁽³⁾
HWAM 3530	10	20	80	-	13 ⁽³⁾	43 ⁽³⁾
HWAM 3610	10	40	90	7	35 ⁽³⁾	63 ⁽³⁾
HWAM 3620	10	40	90	7	20 ⁽³⁾	48 ⁽³⁾
HWAM 3630	10	40	90	-	35 ⁽³⁾	63 ⁽³⁾
HWAM 3640	10	40	90	-	20 ⁽³⁾	48 ⁽³⁾
HWAM 3650	10	40	90	-	35 ⁽³⁾	63 ⁽³⁾
HWAM 3660	10	40	90	-	20 ⁽³⁾	48 ⁽³⁾
HWAM 4620	20	35	130	-	12	41
HWAM 4620, stone cover	20	45	140	-	12	41
HWAM 4640	20	35	130	-	12	41
HWAM 4640, stone cover	20	45	140	-	12	41
HWAM 4660	20	35	130	-	12	41
HWAM 4660, stone cover	20	45	140	-	12	41
HWAM 4680	20	35	130	-	12	41
HWAM 4680, stone cover	20	45	140	-	12	41
HWAM 7150	5	31	80	-	5	33
HWAM 7180	5	31	80	-	5	33
HWAM I 30/45	6/4/14 ⁽¹⁾	6 ⁽²⁾	80	30	-	-
HWAM I 30/55 / HWAM I 30/55s	12/6/15 ⁽¹⁾	8 ⁽²⁾	80	30	-	-
HWAM I 30/65	4/4/14 ⁽¹⁾	4 ⁽²⁾	80	30	-	-
HWAM Classic 4	10	25	80	-	10 ⁽³⁾	39 ⁽³⁾
HWAM Classic 7H	10	25	80	-	15 ⁽³⁾	43 ⁽³⁾

⁽¹⁾ Thickness of insulation, behind/under/over

⁽²⁾ Thickness of insulation

⁽³⁾ **Important!** All dimensions in connection with corner installation are only recommendations. Contact your chimney sweep for a clarification.

HWAM 2610
HWAM 2620
HWAM 2630
HWAM 2640

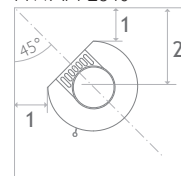

HWAM 3110
HWAM 3120
HWAM 3130

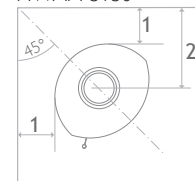

HWAM 3420
HWAM 3520
HWAM 3530

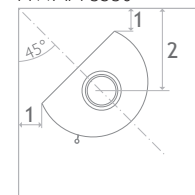

HWAM 3220

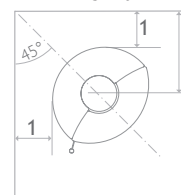

HWAM 3610
HWAM 3620
HWAM 3630
HWAM 3640
HWAM 3650
HWAM 3660

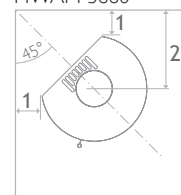

HWAM 4620
HWAM 4640
HWAM 4660
HWAM 4680

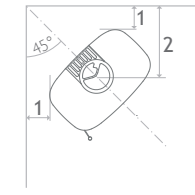

HWAM 7150
HWAM 7180

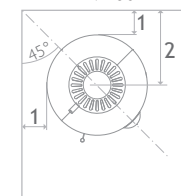

HWAM Classic 4

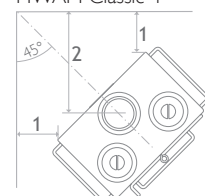

HWAM Classic 7H

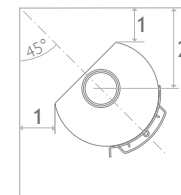

Approvals



	EN 13229 (Europe)	EN 13240 (Europe)	Art. 15a (Austria)	NS 3058/3059 (Norway)	The stove announcement 2015 (Denmark)	LRV (Switzerland)	BlmSchV Stufe 2 (Germany)	BStV München (Germany)	RLU zugelassen (Germany)	DEFRA approved (UK)	Nordic Ecolabel
HWAM 2610		x	x ²⁾	x	x	x	x	x		x	x
HWAM 2620		x	x ²⁾	x	x	x	x	x		x	x
HWAM 2630		x	x ²⁾	x	x	x	x	x	x	x	x
HWAM 2640		x	x ²⁾	x	x	x	x	x	x	x	x
HWAM 3110		x		x	x	x	x	x		x	x
HWAM 3120		x	x ²⁾	x	x	x	x	x	x	x	x
HWAM 3130		x	x ²⁾	x	x	x	x	x	x	x	x
HWAM 3220		x	x ²⁾	x	x	x	x	x	x	x	x
HWAM 3420		x	x ²⁾	x	x	x	x	x	x	x	x
HWAM 3520		x	x ²⁾	x	x	x	x	x	x	x	x
HWAM 3530		x	x ²⁾	x	x	x	x	x	x	x	x
HWAM 3610		x	x ²⁾	x	x	x	x	x		x	x
HWAM 3620		x	x ²⁾	x	x	x	x	x		x	x
HWAM 3630		x	x ²⁾	x	x	x	x	x	x	x	x
HWAM 3640		x	x ²⁾	x	x	x	x	x	x	x	x
HWAM 3650		x	x ²⁾	x	x	x	x	x	x	x	x
HWAM 3660		x	x ²⁾	x	x	x	x	x	x	x	x
HWAM 4620		x	x	x	x	x	x	x	x	(1)	x
HWAM 4640		x	x	x	x	x	x	x	x	(1)	x
HWAM 4660		x	x	x	x	x	x	x	x	(1)	x
HWAM 4680		x	x	x	x	x	x	x	x	(1)	x
HWAM 7150		x	x	x	x	x	x	x	x		x
HWAM 7180		x	x	x	x	x	x	x	x		x
HWAM I 30/45	x			x	x	x	x	x			x
HWAM I 30/55 - HWAM I 30/55s	x			x	x	x	x	x		x	x
HWAM I 30/65	x				x	x					
HWAM Classic 4		x			x	x	x	x			
HWAM Classic 7H		x			x	x	x	x			

⁽¹⁾ Once the catalogue has been completed, we expect the finalization of the approval process, which is currently in progress.

⁽²⁾ Applies only to models with Autopilot IHSTTM.

NB! The table shows the status at the time of the catalogue's publication.
The current status can be obtained at any time from your HWAM dealer and can be checked on www.hwam.com

Test results

	EN 13240/13229					Art. 15a		NS 3058	NS 3059
	CO at 13% O ₂	CO at 13% O ₂	Particle emission at 13% O ₂	Flue gas temperature measured in the outlet socket	Flue gas mass flow	Particle emission	CO	Particle emission	
	%	mg/m ³ _n	mg/m ³ _n	°C	g/s	mg/MJ	mg/MJ	g/kg	
HWAM 2610, Autopilot	0,10	1250	22	366	3,72	-	-	3,42	
HWAM 2610, Autopilot IHS	0,08	1000	16	372	3,55	10	654	2,20	
HWAM 2620, Autopilot	0,10	1250	22	366	3,72	-	-	3,42	
HWAM 2620, Autopilot IHS	0,08	1000	16	372	3,55	10	654	2,20	
HWAM 2630, Autopilot	0,10	1250	22	366	3,72	-	-	3,42	
HWAM 2630, Autopilot IHS	0,08	1000	16	372	3,55	10	654	2,20	
HWAM 2640, Autopilot	0,10	1250	22	366	3,72	-	-	3,42	
HWAM 2640, Autopilot IHS	0,08	1000	16	372	3,55	10	654	2,20	
HWAM 3110, Autopilot	0,07	875	22	300	5,10	-	-	2,05	
HWAM 3120, Autopilot	0,07	875	22	300	5,10	-	-	2,05	
HWAM 3120, Autopilot IHS	0,08	1000	20	307	3,66	13	630	2,45	
HWAM 3130, Autopilot	0,07	875	22	300	5,10	-	-	2,05	
HWAM 3130, Autopilot IHS	0,08	1000	20	307	3,66	13	630	2,45	
HWAM 3220, Autopilot	0,07	875	22	300	5,10	-	-	2,05	
HWAM 3220, Autopilot IHS	0,08	1000	20	307	3,66	13	630	2,45	
HWAM 3420, Autopilot	0,07	875	22	300	5,10	-	-	2,05	
HWAM 3420, Autopilot IHS	0,08	1000	20	307	3,66	13	630	2,45	
HWAM 3520, Autopilot	0,07	875	22	300	5,10	-	-	2,05	
HWAM 3520, Autopilot IHS	0,08	1000	20	307	3,66	13	630	2,45	
HWAM 3530, Autopilot	0,07	875	22	300	5,10	-	-	2,05	
HWAM 3530, Autopilot IHS	0,08	1000	20	307	3,66	13	630	2,45	
HWAM 3610, Autopilot	0,09	1125	18	350	6,00	-	-	1,21	
HWAM 3610, Autopilot IHS	0,10	1250	21	325	5,04	13	756	1,78	
HWAM 3620, Autopilot	0,09	1125	18	350	6,00	-	-	1,21	
HWAM 3620, Autopilot IHS	0,10	1250	21	325	5,04	13	756	1,78	
HWAM 3630, Autopilot	0,09	1125	18	350	6,00	-	-	1,21	
HWAM 3630, Autopilot IHS	0,10	1250	21	325	5,04	13	756	1,78	
HWAM 3640, Autopilot	0,09	1125	18	350	6,00	-	-	1,21	
HWAM 3640, Autopilot IHS	0,10	1250	21	325	5,04	13	756	1,78	
HWAM 3650, Autopilot	0,09	1125	18	350	6,00	-	-	1,21	
HWAM 3650, Autopilot IHS	0,10	1250	21	325	5,04	13	756	1,78	
HWAM 3660, Autopilot	0,09	1125	18	350	6,00	-	-	1,21	
HWAM 3660, Autopilot IHS	0,10	1250	21	325	5,04	13	756	1,78	

Due to the constantly development in our products the valid values may vary from the above mentioned. Updated values are available at your local HWAM dealer and can be seen on www.hwam.com.

Test results

	EN 13240/13229				Art. 15a			NS 3058 NS 3059
	CO at 13% O ₂	CO at 13% O ₂	Particle emission at 13% O ₂	Flue gas temperature measured in the outlet socket	Flue gas mass flow	Particle emission	CO	Particle emission
	%	mg/m ³ _n	mg/m ³ _n	°C	g/s	mg/MJ	mg/MJ	g/kg
HWAM 4620, Autopilot	0,08	1000	28	320	5,9	19	650	1,74
HWAM 4620, Autopilot IHS	0,06	750	29	334	6,6	19	508	1,88
HWAM 4640, Autopilot	0,08	1000	28	320	5,9	19	650	1,74
HWAM 4640, Autopilot IHS	0,06	750	29	334	6,6	19	508	1,88
HWAM 4660, Autopilot	0,08	1000	28	320	5,9	19	650	1,74
HWAM 4660, Autopilot IHS	0,06	750	29	334	6,6	19	508	1,88
HWAM 4680, Autopilot	0,08	1000	28	320	5,9	19	650	v1,74
HWAM 4680, Autopilot IHS	0,06	750	29	334	6,6	19	508	1,88
HWAM 7150, Autopilot	0,06	750	19	282	4,04	13	457	2,05
HWAM 7150, Autopilot IHS	0,07	875	19	276	4,27	14	546	2,45
HWAM 7180, Autopilot	0,06	750	19	282	4,04	13	457	2,05
HWAM 7180, Autopilot IHS	0,07	875	19	276	4,27	14	546	2,45
HWAM I 30/45	0,10	1250	37	240	5,90	-	-	3,43
HWAM I 30/55 - HWAM I 30/55s	0,09	1125	26	296	5,51	-	-	3,31
HWAM I 30/65	0,12	1500	28	350	9,07	-	-	-
HWAM Classic 4	0,10	1250	36	255	9,90	-	-	-
HWAM Classic 7H	0,09	1125	39	260	13,20	-	-	-

Due to the constantly development in our products the valid values may vary from the above mentioned. Updated values are available at your local HWAM dealer and can be seen on www.hwam.com.

Unique Details

Unique Door System

All HWAM stoves designed by the duo Strand + Hvass are equipped with an exclusive lifting door.

The door is constructed so that it opens and closes with one steady, balanced vertical movement. When the door is closed, it silently glides into position and completely seals the opening.

The lifting door's vertical sliding movement minimizes the turbulence in the combustion chamber, which prevents ash from escaping into the room when the door is opened. This is convenient for you as it means less cleaning around the stove.

Unique Closing System

Thanks to the unique locking system, the stove has a tightly fitting door and offers simple and easy servicing.

You simply need to slightly pull the handle in order to open the door. When the door is closed, the closing hook grabs and pulls the door.

This closing system is found on all models in the series HWAM 2600, HWAM 3100, HWAM 3200, HWAM 3400, HWAM 3500, HWAM 3600, HWAM 4600, HWAM 7100 and on the inserts HWAM I 30/65 and HWAM I 30/55s.

Silent feet

All models in the series HWAM 2600, HWAM 3100, HWAM 3200, HWAM 3400, HWAM 3500, HWAM 3600 and HWAM 4600 have hidden adjustable silent feet (except models on pedestal).

Even if the floor is not exactly even, you can quickly and easily get your HWAM stove to stand straight by adjusting the silent feet.

Unique Door System



Unique Closing System



Heat storage

Principle sketch, with HWAM Autopilot™

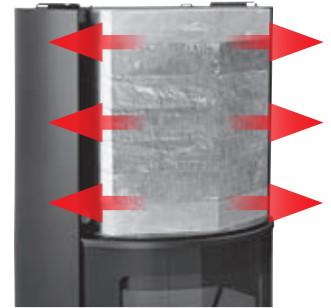
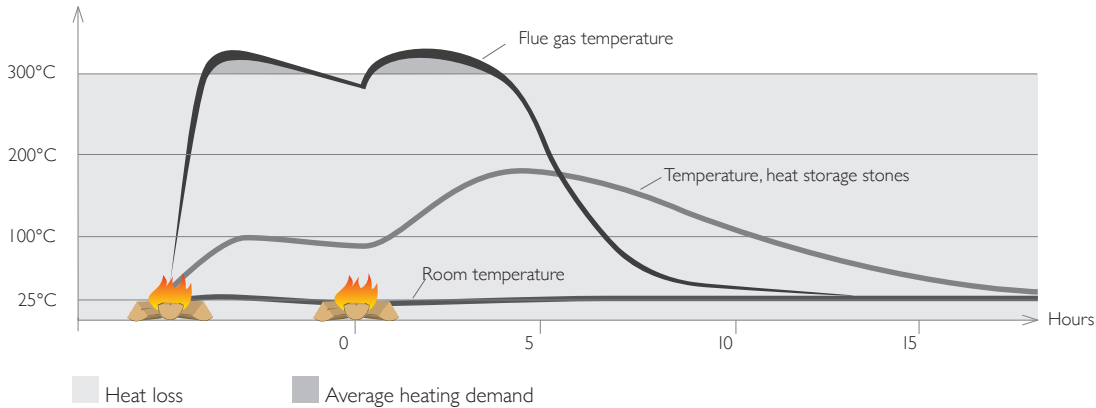

Heat storage

The storage of heat is a phenomenon known from large masonry stoves where heat is stored in the stones surrounding the combustion chamber.

Heat storage in a wood-burning stove combines the home stove's ability to quickly and comfortably distribute the convection heat with the masonry stove's ability to store heat.

HWAM 3130, HWAM 3500, HWAM 3650, HWAM 3660, HWAM 4660, HWAM 4680 and HWAM 7100 are equipped with heat storage. The heat storage can be filled with a large amount of stones, which have the special ability to store heat from the stove and slowly release heat into the room, even long after the fire has stopped burning. This makes it possible to enjoy the benefits of the stove's convection heat and a masonry stove's heat storage ability at the same time. All wrapped in a stylish HWAM design.

While the wood is burning in the stove, the stones are heated inside the heat storage. When the fire in the combustion chamber has stopped burning, the stones continue to release the heat that they have stored. This way you get a continuous and pleasant heat supply for the room long after the fire has gone out. Tests show that the heat storing stones may stay warm for up to 8-14 hours after the last fire has gone out.

As an extra feature, the heat storage compartment is equipped with a regulation handle that opens or closes the access for convective air flow to the heat storage. With the convection valve closed, the heat storage will keep the stored heat for as long as possible, whereas the heat will be emitted to the room as quickly as possible when the valve is opened.

